



# Installation Guide for **Blink** Series

## ■ Step 1 : Download the APP

**1.1** Download the "**Smart Life**" & "**Alexa**" app from **Apple App Store** or **Google Play** to your phone (If already downloaded, skip.)

**1.2** Create "**Smart Life**" & "**Alexa**" account (If registered, skip.)

**1.3** Download "**Blink**" app (If already downloaded, skip.)



Smart Life



Amazon Alexa



GET IN ON  
**App Store**



GET IN ON  
**Google Play**

## ■ Step 2 : Add the Doorbell Extender to Smart Life

### 2.1 Plug in & Power up

Plug the Video Doorbell Extender into an outlet.

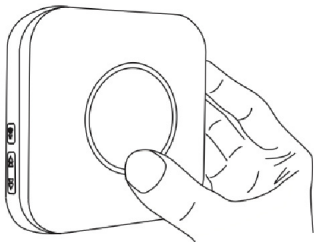
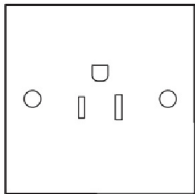

## 2.2 Pairing Doorbell Extender

2.2.1 Press and hold the Ring tone button  on the device until the indicator is flashing red .

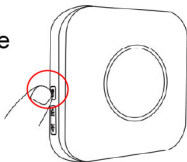

2.2.2 Open the "**Smart Life**" app click the "+" button on the top right corner, select "**Add Device**"

2.2.3 Click  
"**Wireless Doorbell**"  
and **Add**



## 2.3 Enter Wi-Fi password (Note: suggestion match your phone's Wi-Fi).

(only supported **2.4GHz** networks)

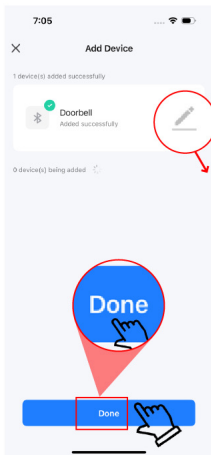
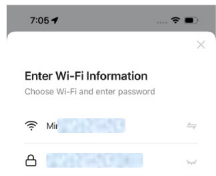

Customize  
Extender  
Names

## ■ Step 3 : Link Smart Life with Alexa

### 3.1 Open the **Smart Life** app:

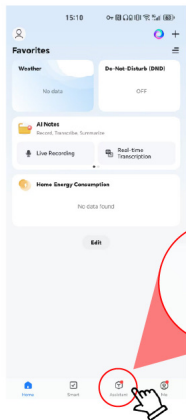

① Click the  
"  " in the  
navigation bar

## ② select "More assistants"

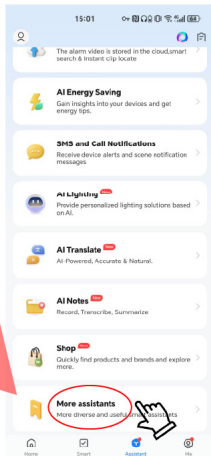

## ③ locate and select "Alexa"

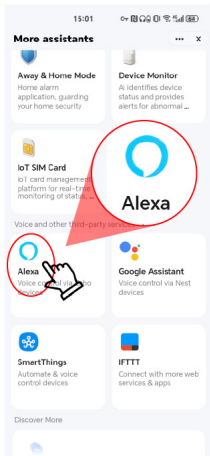

**3.2** Follow the on-screen prompts to complete the connection.

- ④ select **"Link to Amazon Alexa"**    ⑤ select **"Link"**    ⑥ select **"Done"**



#### "SmartLife" on "Amazon Alexa"

Not yet linked to this App account, "Amazon Alexa" cannot obtain device status and control permissions.



#### Link SmartLife with Alexa

Enable the SmartLife skill and link your account with Alexa.

To unlink your account at any time, disable the skill in the Alexa app.



#### Link Successful

You can now control the device through the Amazon Alexa.



## ■ Step 4 : Link **Blink** with Alexa

**4-1** Open the **Blink** app,  
Log in to your **Blink**  
account (already  
logged in, please skip)

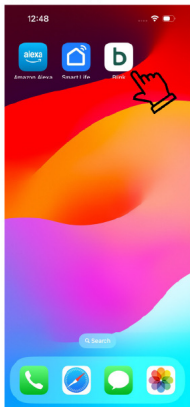

**4-2** Click the ' **Settings** ' in the navigation bar.  
Select '**Account and Privacy** ' in the settings.

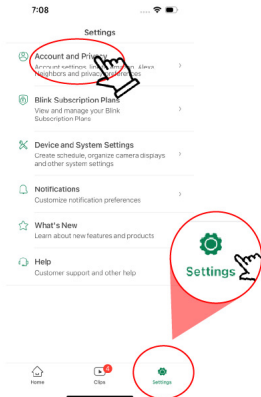

### ③ Select 'Alexa'

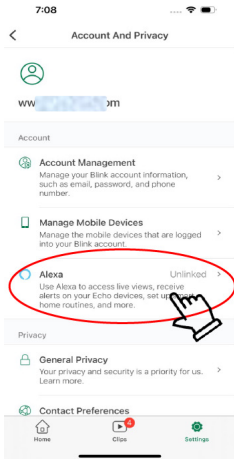

### ④ Select 'Link Alexa'

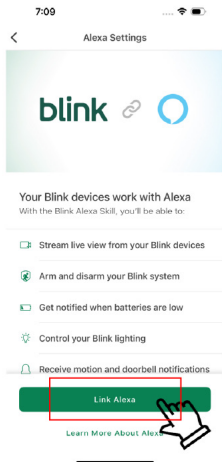

## ⑤ Select 'AGREE'



### Let's link your Blink and Alexa accounts

When you link accounts, Blink and Amazon will use account information to provide integrated features and services and as otherwise described in [Blink's Privacy Notice](#) and [Amazon's Privacy Notice](#).

Blink Alexa Skill will be turned on so you can hear Blink alerts and answer the door through Alexa devices.

Once you link your Blink account with an Amazon account, anyone who has access to that Amazon account may access your Blink devices and videos on compatible devices.



## ⑥ Select 'LINK'



### Link Blink SmartHome with Alexa

Enable the Blink SmartHome skill and link your account with Alexa.

To unlink your account at any time, disable the skill in the Alexa app.



## ⑦ Successfully linked

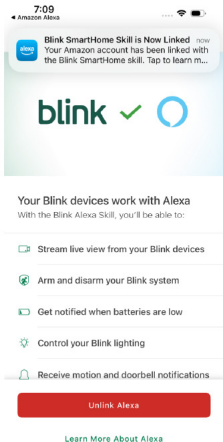

## ■ Step 5 : Set up Alexa

### 5-1 Create Routine:

① Open the **Alexa** app

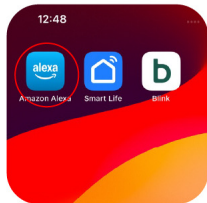

② Click the ☰

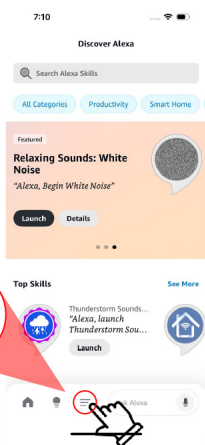

## ③ Select 'Routines'

## ④ Select 'Your Routines' Then Create Routine

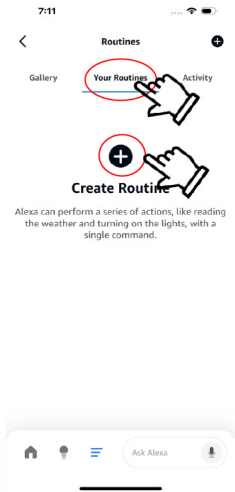
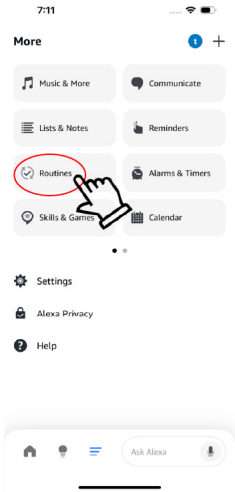

## 5-2 Create 'WHEN' event:

⑤ Click "+",  
create 'WHEN' event

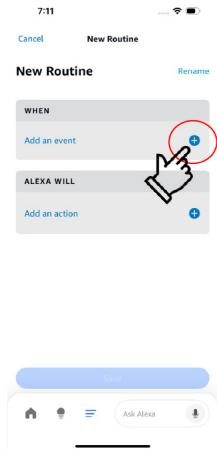

⑥ Select  
'Smart Home'

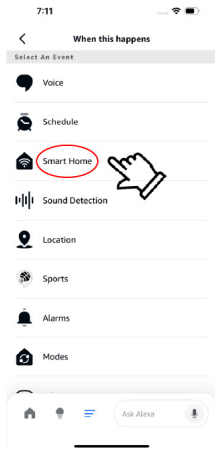

⑦ Select  
'Video  
Doorbell -\*\*\*'



⑧ Select  
'Doorbell '

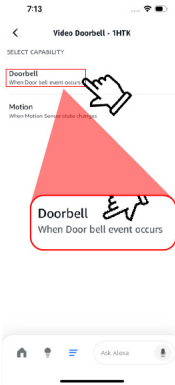

⑨ Select  
'Save '

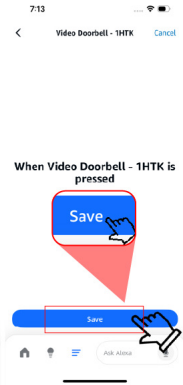

## 5-3 Create 'ALEXA WILL' event:

① Click "+", create  
'ALEXA WILL'  
event

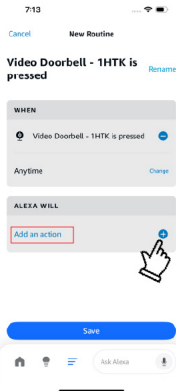

② Select  
'Smart Home'

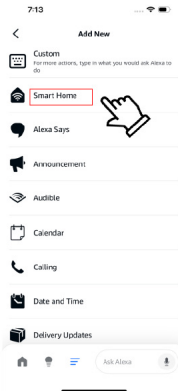

③ Select  
'Doorbells'

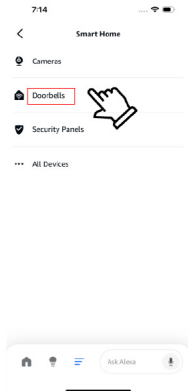

#### ④ Select 'Doorbell'

#### ⑤ Select 'Alert Mode'

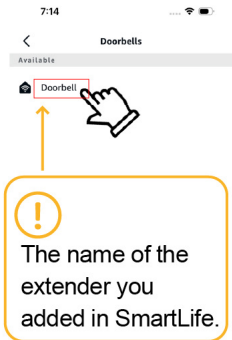

⑥ Choose the mode you need

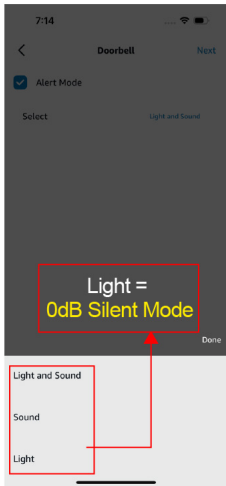

⑦ Finished then select "Next"

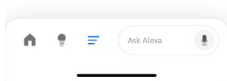
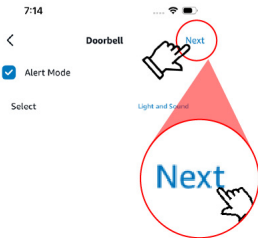

## ⑧ Select 'Save'

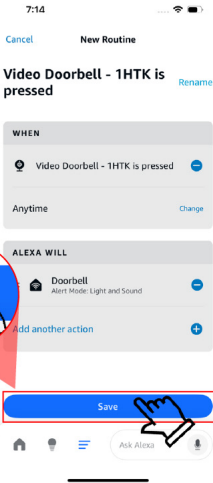

## ⑨ Routine created successfully

